

SRI KARUMARIAMMAN NAGAR 卐

PLAN SHOWING THE LAY-OUT OF HOUSE SITES IN S.NO. 117/4B part OF KAVANUR VILLAGE & PANCHAYAT, SRIPERUMBUTHUR TALUK & KANCHIPURAM DISTRICT.
PANCHAYAT APPROVAL NO - 53/2012-2013.

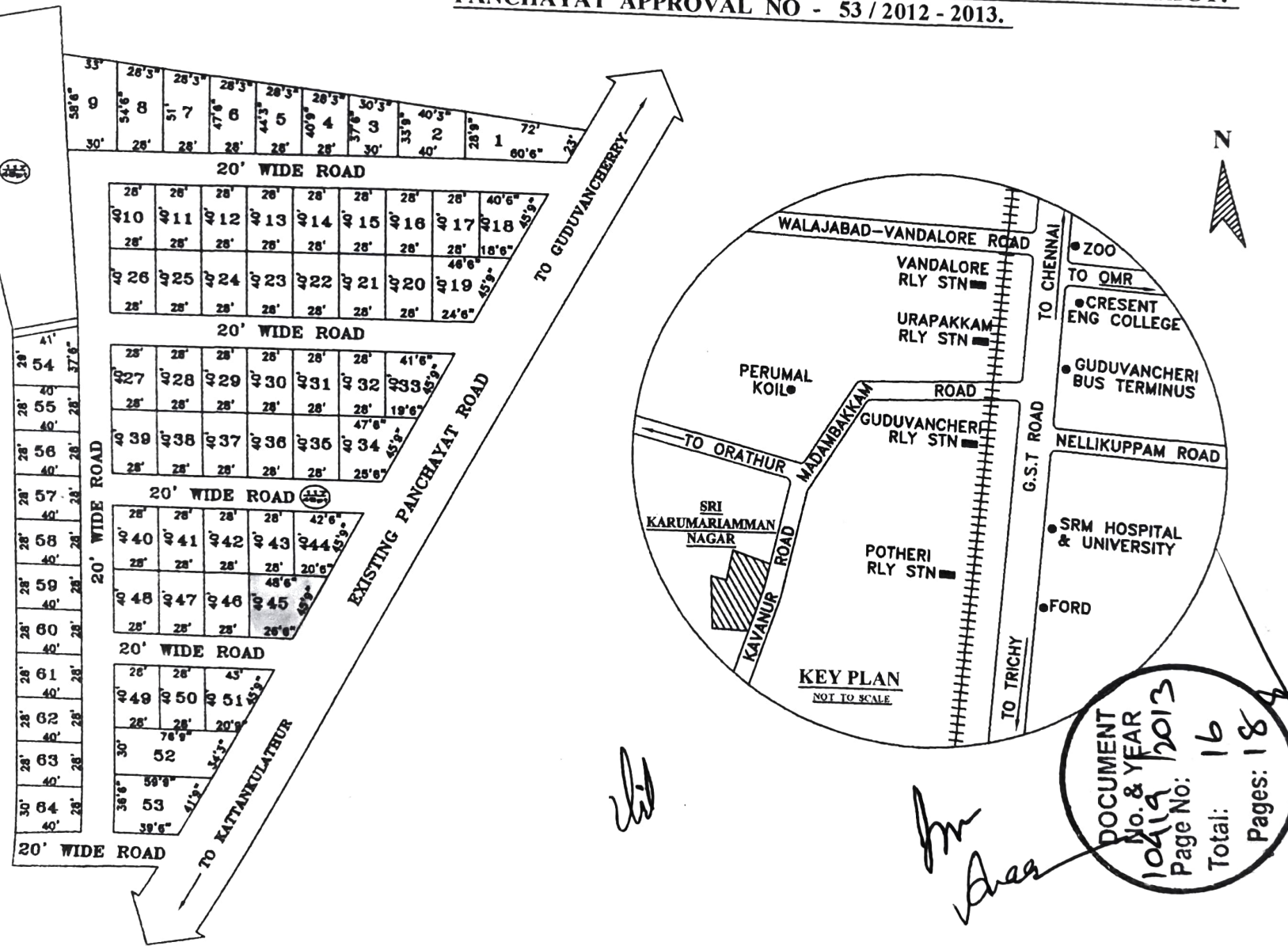

PLOT NO	EXTENT SqFt	PLOT NO	EXTENT SqFt
1	1714	33	1308
2	1254	34	1565
3	1073	35	1120
4	1100	36	1120
5	1195	37	1120
6	1290	38	1120
7	1385	39	1120
8	1484	40	1120
9	1780	41	1120
10	1120	42	1120
11	1120	43	1120
12	1120	44	1351
13	1120	45	1608
14	1120	46	1120
15	1120	47	1120
16	1120	48	1120
17	1120	49	1120
18	1265	50	1120
19	1522	51	1367
20	1120	52	2193
21	1120	53	1942
22	1120	54	1346.5
23	1120	55	1120
24	1120	56	1120
25	1120	57	1120
26	1120	58	1120
27	1120	59	1120
28	1120	60	1120
29	1120	61	1120
30	1120	62	1120
31	1120	63	1120
32	1120	64	1160

DOCUMENT
 No. & YEAR
 10419/2013
 Page No:
 Total: 16
 Pages: 18

Handwritten signatures and initials.

SCHEDULE- B
(Description of the Immovable Property)

All that piece and parcel of Vacant house site bearing Plot No.45 in "Sri Karumari Amman Nagar" Layout (Layout approved by Kavanur Panchayat vide Approval No.53/2012-13) situated at Old No.196, New No.167, Kavanur Village, Chennai - 603202, Sriperumbudhur Taluk, Kancheepuram District, bearing Patta No.1738, comprised in Survey No.117/4B (Old S.No.117/4B2 & 117/4B3) measuring an extent of 1608 Sq.ft., and the land bounded on the

North by	:	Plot Nos.43 & 44
South by	:	20 feet wide road
East by	:	Existing Panchayat Road
West by	:	Plot.No.46.

Measuring on the

North by	:	48 feet 6 inches
South by	:	26 feet 6 inches
East by	:	45 feet 9 inches
West by	:	40 feet

Situate within the Sub Registration District of Guduvanchery and in the Registration District of Chennai South.